

PTEX1-HU



ANALYSIS LTD



[www.analysis-ltd.com.gr](http://www.analysis-ltd.com.gr)

# HAMMER UNION PRESSURE TRANSMITTER

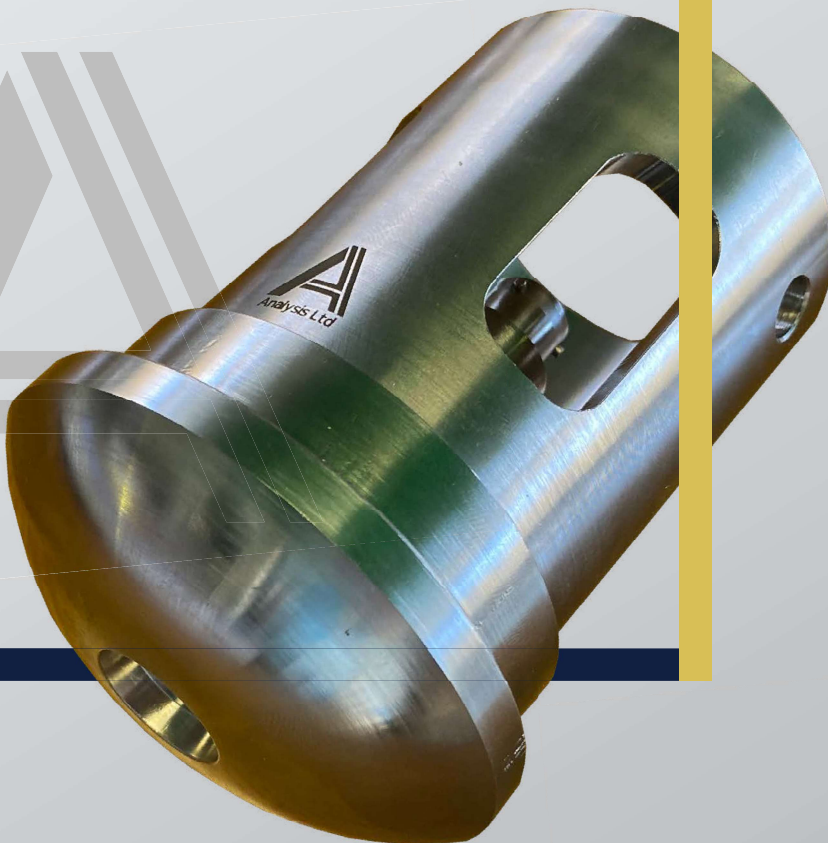



**APPLICATIONS**

Excavations and pumps  
 Oil and gas , production  
 Mud Pumps

**APROVALS AND CERTIFICATIONS**

ATEX (Certificate number = Ex Veritas 21ATEX0865X)  
 IECEx (Certificate number = IECEx EXV 21.0037X)  
 ATEX and IECEx certified Zone 0 and Zone 20 Category 1  
 IIIG Ex ia IIC T4 Ga  
 IIID Ex ia IIIC T200 107°C Da  
 Type approval Lloyd's Register(Cert. number=LR22230526TA)

**IP PROTECTION**

For all connector versions IP66

**TEMPERATURE SPECIFICATIONS**

Media temperature	-40 to 100 C
Ambient temperature	-40 to 80 C
Storage temperature	-40 to 80 C

**FEATURES**

Reliable and accurate pressure measurement  
 Accuracy (non-linearity, hysteresis and repeatability)  $\leq \pm 0.25\%$  of span  
 Measuring ranges 5000PSI, 10000PSI, 15000PSI and 20000PSI others on request  
 Working temperature -40 to 80C  
 Supply voltage 11 to 28VDC  
 Output 4 to 20mA  
 Process Connection Hammer Union 1502  
 Wetted parts Inconel 718 and AIS316  
 Designed for harsh environments

**OPERATION CONDITIONS**

Shock Resistance	2-13.2Hz at 3 1mm and from 13.2-100Hz at 0.7g
Vibration Resistance	2-25Hz at 3 1mm and from 25-100Hz at 4.0g

**ELECTRICAL SPECIFICATIONS**

Supply voltage	11 to 28 VDC	
Output	4...20 mA	(2 wires connection)



**MATERIALS**

Wetted parts Inconel 718 and AISI316  
 Body material AISI316

**PRESSURE REFERENCE**

PSI  
 Bar

**TESTS AND SPECIFICATIONS**

Environmental	Cold: EN60068-2-1 Dry Heat: EN60068-2-2 Damp heat: EN60068-2-30 Vibration: EN60068-2-6,
Electrical installations	EN 60092-504
Static Inclination	EN 60092-504
Dynamic Inclination	EN 60092-504
Electrostatic Discharge	EN 61000-4-2
Radiated RF Immunity	EN 61000-4-3
Fast Burst Transients	EN 61000-4-4
Conducted RF Immunity	EN 61000-4-6
Radiated Emissions	EN 55016-2-3
Power Supply Variation	EN 60092-504
Power Supply Failure	EN 60945
Insulation Resistance	EN 60945

**ELECTRICAL SPECIFICATIONS**

Reverse polarity protection	Yes
Output Impedance	>10k Ohms
Max load in Ohms	$\leq (\text{supply voltage} - 11 \text{ V}) / 0.021 \text{ A} - (\text{cable length per m} \times 0.15 \text{ Ohms})$
Voltage insulation	500V tested
Insulation resistance	>10Mohms

**PARAMETERS ACCORDING TO ATEX-IECEX**

Entity parameters	Values for gas atmospheres	Entity parameters for dust atmospheres
Ui	28 V	28 V
Ii	119 mA	88 mA
Pi	833 mW	616 mW
Ci	10 nF	10 nF
Li	1.2 uH	1.2 uH
C & L per unit length (cable version)	150 pF/m and 1.1 uH/m	150 pF/m and 1.1 uH/m

**ACCURACY SPECIFICATIONS**

Accuracy (non-linearity, hysteresis and repeatability)	$\leq \pm 0.25 \%$ of FS, typ
Temperature error every 10C	$\leq \pm 0.1 \%$ of FS, typ
Over range Protection	1.5X Rated Pressure
Burst Pressure	2.5X Rated Pressure
Pressure Cycles	> 100 million at full pressure

1.Power supply: 24VDC, Temperature: 18 to 24C, Mount position: Vertical, Humidity: 45 to 75%





DIMENSIONS

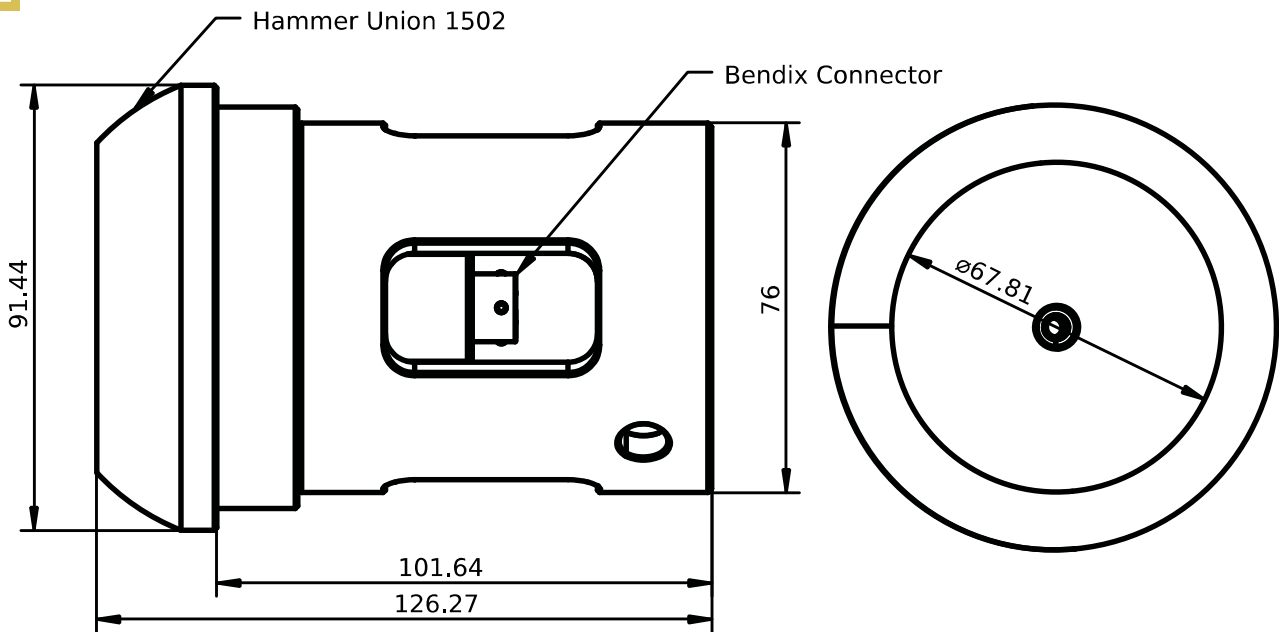

ELECTRICAL CONNECTION

Bendix MIL-DTL-26482  
Bayonet connector

A --> +    B --> -

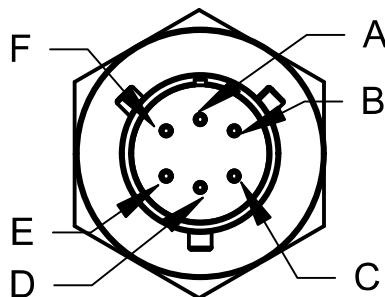



**INTRINSICALLY SAFE BARRIER CONNECTION**

Sensor must not exceed upper or lower limits of the barrier of the entity parameters (following conditions must be satisfied):

Checking of the voltage:  $U_o$  (barrier)  $\leq$   $U_i$  (sensor in hazardous area)

Checking of current:  $I_o$  (barrier)  $\leq$   $I_i$  (sensor in hazardous area)

Checking of power:  $P_o$  (barrier)  $\leq$   $P_i$  (sensor in hazardous area)

Checking of capacitance:  $C_c$  (cable) +  $C_i$  (sensor in hazardous area)  $\leq$   $C_o$  (barrier)

Checking of inductance:  $L_c$  +  $L_i$  (sensor in hazardous area)  $\leq$   $L_o$  (barrier)

Entity parameters: Please see at page 3

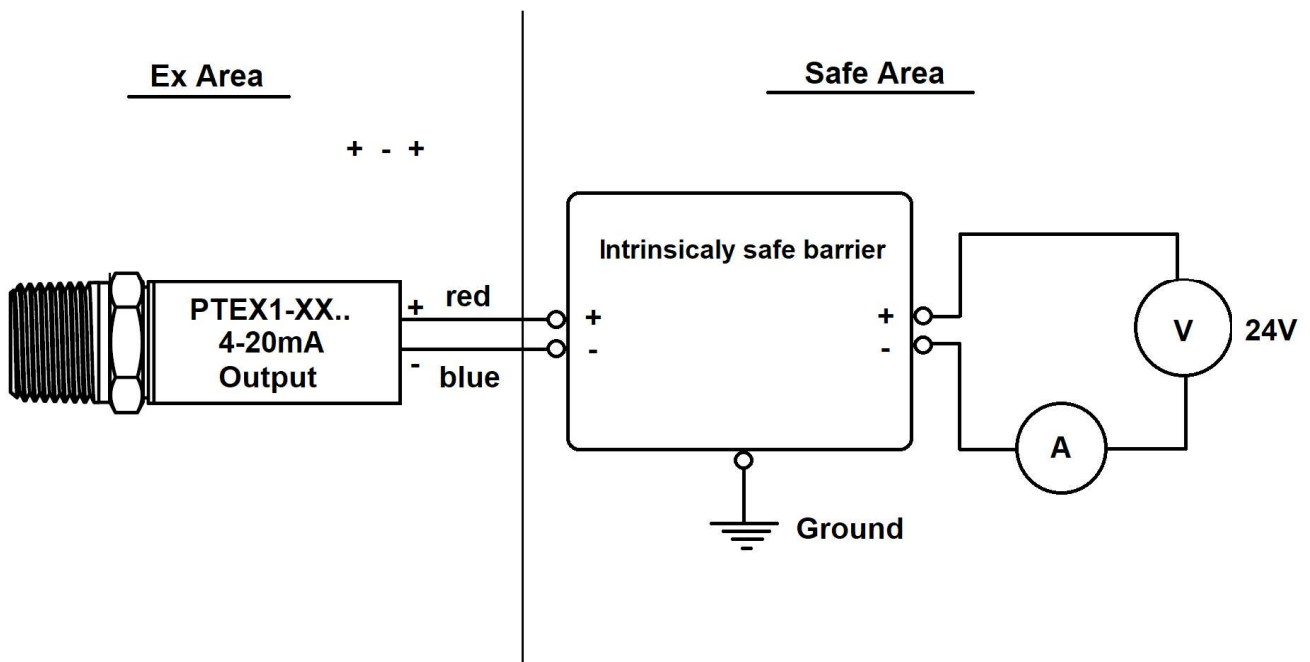

PTEX1-HU

ORDER CODE



ANALYSIS LTD

ORDER CODE FOR PTEX1

**ELECTRICAL CONNECTION CHOISE**

Connector

HU

**ELECTRICAL CONNECTION**

Bendix MIL-DTL-26482 Bayonet connector

BEN

**OUTPUT**

4...20 mA (2 wires connection)

420A

**PRESURE REFERENCE**

Bar

B

PSI

P

**PRESURE RANGES**

0 to 5.000 psi

005K

0 to 10.000 psi

010K

0 to 15.000 psi

015K

0 to 20.000 psi

020K

Other pressure reanges on request

----

**Wetted parts Material**

Inconel 718 and AISI 316 body

IN76

**PROCESS CONNECTION**

Flange 1502

1502

Other connection on request

XXX

www.analysis-ltd.com.gr

Delta Velestino, 375 00 Magnesia, Greece tel. 0030 2425024248

Version: PTEX1.3HU-06-2024

Analysis Ltd can accept no responsibility for errors in datasheets, catalogues and other electronic or printed materials. Analysis Ltd reserves the right to change specifications without notice. All trademarks in this material are property of Analysis Ltd. Copyright© 2017 Analysis Ltd. All rights reserved.

